

C 1	FIGURE 2	64	● 228855	1	
A 2	92879	1	C 65	● 300870	1
3	228968	1	66	229250 M5x8	2
4	● 229237	2	67	228597	1
5	● 228975 M5x55	2	68	228853	1
C 6	228929 MAC-ZETA-PM 1	C 69	235115	1	
C	227609 CALIFORNIA 901	B 70	235864 .325"	1	
C	240799 EUROMAC 1	B	95646 3/8"	1	
C	229466 TITAN 1	B 71	235287	1	
7	● 229164 M4x35	1	B 72	235073	1
8	● 235048	2	B 73	229137	1
9	● 235040	1	74	235812 M5x16	1
B 10	● 235372	1	75	237001 MAC-PM-ZETA 1	
A 11	● 235042	1		237055 CALIFORNIA 901	
12	● 235431	1		240800 EUROMAC 1	
13	● 235944	1		229464 TITAN 1	
14	229018	1	76	● 228943	2
15	229082	2	C 77	228934	1
16	240592	2	A 78	235217	2
17	228653	1	A 79	235574	1
18	235218	1	80	● 235367	1
19	235138 Prefix 02	1	82	228955	1
	241204 Prefix 03	1	83	235184	1
B 20	● 235518	2	84	235205	1
B 21	● 235517	2	85	235226	1
B 22	● 235516	2	C 86	229064	1
C 23	228416	1	87	229740	1
24	● 235238	1	88	235177	1
25	228139	1	89	236997 M5x30	7
26	235806 M5x20	4	B 90	240674	1
B 27	235551	1	91	228907 M5x52	2
C 28	● 235510	1	C 92	228909	1
B 29	235552	1	93	228908 M4x14	4
C 30	● 235511	1	C 94	226022	1
31	235716	1	A 95	227692	1
C 32	● 235741	1	96	229129	1
B 33	● 229809	1	98	236732	1
C 34	● 235675	1	C 99	235281	1
A 35	● 240452	1	C100	FIGURE 3	
36	240592	2	101	228655 MAC-PM-TITAN 1	
37	227565 M5x25	4		229145 CALIFORNIA 90-ZETA 1	
38	235802 M5x14	8		240816 EUROMAC 1	
B 39	240673	2	102	228910	1
40	247716	1	103	235020	1
41	● 228935	2	104	235225	2
42	● 228122	1	105	235163	1
43	● 235190	1	106	235216	4
44	● 235230	1	107	228911	1
45	● 235900	1	C108	240672	1
46	● 235899	1	B109	228892	1
C 47	● 228872	1	110	228722 MAC-PM-TITAN 1	
48	● 235222	1		237054 CALIFORNIA 901	
49	● 94006	1		229216 ZETA 1	
50	● 235075	1		240797 EUROMAC 1	
51	● 235221	1	111	229163 M5x30	2
C 52	● 235229	1	C112	246729 MAC-PM-EUROMAC 1	
53	235729	1		ZETA-CALIFORNIA 90	
C 54	● 229260	1	C	246795 TITAN 1	
56	235670	1	C113	● 228913	1
57	235672	1	C114	● 228922	1
58	240937 Prefix 02	1	115	● 229088	1
	241202 Prefix 03	1	C116	● 240841	1
C 59	● 235742	1	C117	● 228138	1
C 60	102164 Prefix 02	1	118	● 240862	5
C	227631 Prefix 03	1	B119	240675	1
61	229075	1	120	235248	5
B 62	246660	1	121	240669	1
C 62A	● 228854	1	122	229217	1
63	● 240164	1			

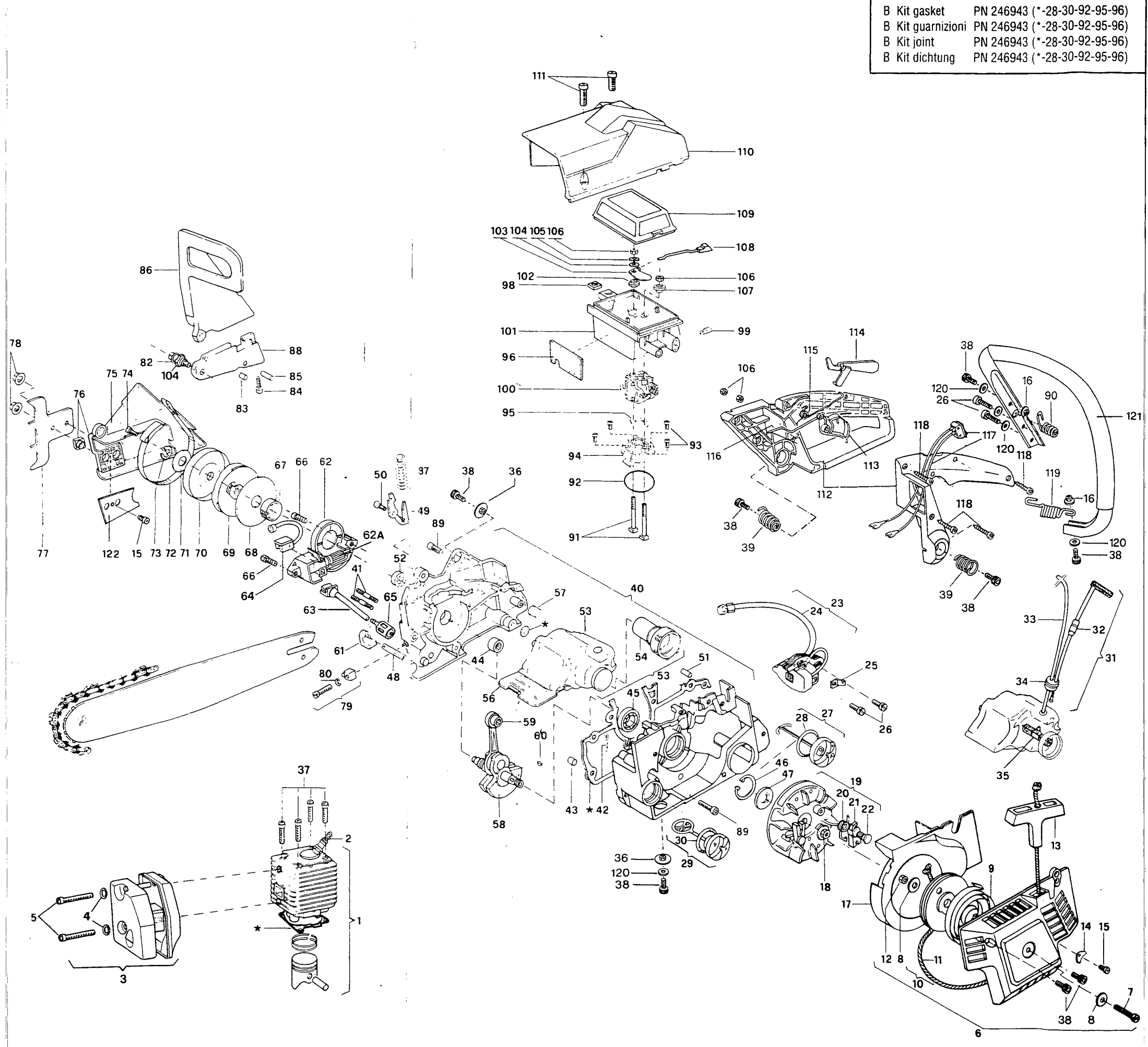

B Kit gasket PN 246943 (\*-28-30-92-95-96)  
 B Kit guarnizioni PN 246943 (\*-28-30-92-95-96)  
 B Kit joint PN 246943 (\*-28-30-92-95-96)  
 B Kit dichtung PN 246943 (\*-28-30-92-95-96)

**FIGURE 1**

A = high moving - alta rotazione - haute demande - große Nachfrage  
 B = medium moving - media rotazione - moyenne demande - mittelmäßige Nachfrage

# Order McCulloch Pro Mac parts on eBay

	<b>30 cc</b>	C 1     247713     1 B 2     ●     235135     1 C 3     ●     235376     1 4     ●●     235008     2 B 5     ●●     235006     2
	<b>35 cc</b>	C 1     247714     1 B 2     ●     235135     1 C 3     ●     235799     1 4     ●●     235008     2 B 5     ●●     235677     2
	<b>40 cc</b>	C 1     247715     1 B 2     ●     235135     1 C 3     ●     235797     1 4     ●●     235008     2 B 5     ●●     235678     2

**FIGURE 2**

<b>WALBRO</b>	
<b>WT 113</b>	C - <b>229439</b> carbur. B 1     ● 229198     1 A 2     ●● 229191     1 3     ● 226037     1 4     ● 226038     1 5     ● 226039     1 6     ● 229600     1 7     ● 246953     1 8     ● 229927     1 9     ● 229601     1 C 10   ● 246952     1
<b>30 cc</b>	
<b>WT 130</b>	C - <b>229597</b> carbur. B 1     ● 229198     1 A 2     ●● 229191     1 3     ● 246951     1 4     ● 226038     1 5     ● 226039     1 6     ● 229600     1 7     ● 246954     1 8     ● 229927     1 9     ● 229601     1 C 10   ● 246952     1
<b>35 cc</b>	
<b>WT 55</b>	C - <b>228527</b> carbur. B 1     ● 229198     1 A 2     ●● 229191     1 3     ● 226037     1 4     ● 226038     1 5     ● 226039     1 6     ● 229600     1 7     ● 229599     1 8     ● 229927     1 9     ● 229601     1 C 10   ● 246952     1
<b>40 cc</b>	

<b>ZAMA</b>	
<b>C1Q M24</b>	C - <b>229738</b> carbur. B 1     ● 226226     1 A 2     ●● 226227     1 3     ● 226228     1 4     ● 226229     1 5     ● 226230     2 6     ● 226231     1
<b>30 cc</b>	
<b>C1Q M25</b>	C - <b>229739</b> carbur. B 1     ● 226226     1 A 2     ●● 226227     1 3     ● 226228     1 4     ● 226229     1 5     ● 226230     2 6     ● 226231     1
<b>35 cc</b>	
<b>C1Q M26</b>	C - <b>229990</b> carbur. B 1     ● 226226     1 A 2     ●● 226227     1 3     ● 226233     1 4     ● 226234     1 5     ● 226230     2 6     ● 226231     1
<b>40 cc</b>	

**FIGURE 3**

A = high moving - alta rotazione - haute demande - große Nachfrage  
 B = medium moving - media rotazione - moyenne demande - mittelmäßige Nachfrage  
 C = slow moving - bassa rotazione - basse demande - wenige Nachfrage