

10 - PARTS LIST

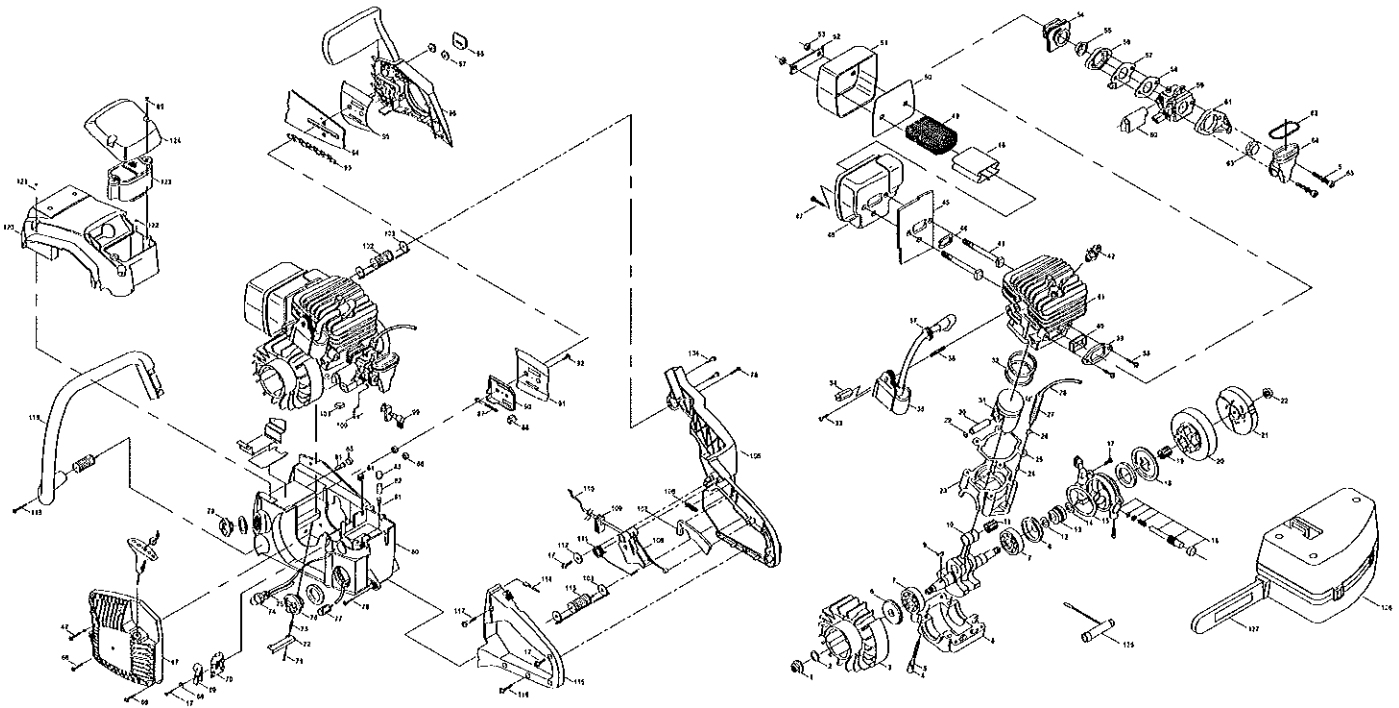

Item.	Parts No.	Description	Item.	Parts No.	Description	Item.	Parts No.	Description
1	9NAB-5/16-24	NUT	45	9082-310201	BAFFLER	89	9214-310101	SCREW
2	9WOC-08	NUT	46	9228-310217	MUFFLER BODY ASS'Y	90	9043-310203	PLATE, BAR
3	9169-310201	FLYWHEEL	47	9SKKBY10/24-0.5	SCREW	91	9043-310202	PLATE, FLANGE
4	9SREB-10/24-2.75	SCREW	48	9211-310201	PLATE	92	9SKKBY6/19-0.375	SCREW
5	9WFB-0.2	WASHER	49	9183-310201	SCREEN	93	9220-31B203	20" CHAIN
6	9157-310201	SEAL	50	9082-310205	BAFFLER	94	9040-31A219F	20" BAR
7	9DB-620201	BEARING	51	9017-310204	COVER, MUFFLER	95	9082-310204	PLATE
8	9072-3102Y1F	CRANKCASE LOWER	52	9158-310201	LOCKPLATE	96	9228-310215	CHAIN BRAKE ASS'Y
9	9221-310001	KEY	53	9NAC-10/24	NUT	97	9NAZ-5/16-18	NUT
10	9228-310203A	C'SHAFT/C'ROD ASS'Y	54	9124-310202	BOOT, CARBURETOR	98	9072-310206	PLATE
11	9155-310201	BEARING	55	9131-310203	EYELET	99	9228-31C201	CKOKE ASS'Y
12	6014-M96A01	WASHER	56	9014-310204	FLANGE	100	9114-310202	ROD, CHOKE
13	9073-310201	GEAR, WORM	57	9102-310202	PLATE	101	9013-310202	PLUG
14	9WFN-0.4	WASHER	58	9014-310202	GASKET	102	9228-310213	ISOLATOR ASS'Y
15	9076-310201	O RING	59	9287-31C201	CARBURETOR	103	9228-310214	CABLE ASS'Y
16	9228-310235	PUMP ASS'Y	60	9124-310203	BOOT 1	104	9SGKBY10/24-0.5	SCREW
17	9SKKBY8/16-0.5	SCREW	61	9014-31C201	FLANGE	105	9068-310203	FRAME, REAR
18	9WDZ-0.722	WASHER	62	9024-310202	SPRING	106	9017-31C201	PLUG
19	9036-310201	BEARING	63	9131-310204	EYELET	107	9028-310201	RELEASE, TRIGGER
20	9228-310211	FRUM SPRKT ASS'Y	64	9124-310204	BOOT	108	9028-310202	TRIGGER
21	9228-310210	CLUTCH ASS'Y	65	9SREB-10/24-1.625	SCREW	109	9124-310209	GROMMET
22	9NHC-09	NUT	66	9SKKBY10/14-0.625	SCREW	110	9010-310201	CABLE
23	9072-3102Y2F	CRANKCASE UPPER	67	9228-310212	STARTER ASS'Y	111	9024-310206	SPRING
24	9124-310201	FITTING, PULSE LINE	68	9WFZ-0.18	WASHER	112	9WFB-4.9-17	WASHER
25	9014-3102Y1	GASKET	69	9223-310201	WIRE	113	9228-310222	ISOLATOR ASS'Y
26	9036-310201	CLAMP, WIRE HOSE	70	9183-310202	SCREEN	114	9010-310203	WIRE ASS'Y
27	9059-310201	CONDUIT, FLEX	71	9SKKBY10/24-1	SCREW	115	9228-310232	COVER ASS'Y, HANDLE
28	9129-310004	HOSE	72	9043-310201	PLATE	116	9SKKBY8/16-0.625	SCREW
29	9CA-0.46	RING	73	9124-310206	SPACE	117	9SKKBY-8/16-1	SCREW
30	9PG-10-32.5	PIN	74	9142-310002	PRIMER, REMOTE	118	9SJKB-12/14-1.5	SCREW
31	9290-31C201	PISTON	75	9129-310214	HOSE	119	9228-310231	HANDLE ASS'Y
32	9189-31C201	RING, PISTON	76	9228-310206	CAP, FUEL	120	9228-310216	COVER ASS'Y
33	9SKKBY10/24-0.75	SCREW	77	9182-310503	FILTER, FUEL	121	9SKKBY10/14-02	SCREW
34	9124-310205	SPACER	78	9SKKZY10/14-01	SCREW	122	9SKKBY10/14-0.68	SCREW
35	9288-310201-CH	IGNITION ASS'Y	79	9228-310207	CAP, OIL	123	9228-310204	AIR CLEANER ASS'Y
36	9191-310201	STUD	80	9228-310205	FUEL/OIL TANK ASS'Y	124	9067-310202	COVER
37	9012-330301	GROMMET	81	9070-310002	VALVE DUCKBILL	125	9042-310201	WRENCH
38	9SKKBY10/24-0.62	SCREW	82	6182-210101	FILTER	126	9120-310201	CARRY CASE
39	9014-310203	FLANGE	83	9129-310209	HOSE	127	9017-310213	SCABBARD
40	9131-310202	EYELET	84	9013-310201	PLUG			
41	9292-31C201F	CYLINDER	85	9252-310002	FILTER			
42	9295-320001	SPARK PLUG	86	9131-310206	WASHER			
43	9STDZY10/24-2.79	SCREW	87	9214-310201	SCREW			
44	9014-310208	WASHER	88	9035-310201	NUT			

* 753-05116 Adjusting Screw Kit
(Not pictured)